

EVOLUTION EDGES™

A DIVISION OF CHEMUNG SUPPLY

PRODUCT CATALOG



HEADQUARTERS:
2420 CORNING ROAD
ELMIRA, NY 14903
P: 607-733-5506
F: 607-732-5379



A DIVISION OF CHEMUNG SUPPLY

WEBSITE / www.EvolutionEdges.com
 PHONE / 800-733-5508
 FAX / 607-732-5379
 ADDRESS / 2420 Corning Road
 Elmira, NY 14903

SALES TERRITORIES AND CONTACT INFORMATION

MATT AQUINO

Sales Manager
 CELL PHONE / 585-613-6821
 EMAIL / Info@BuiltBlades.com

JASON EOFF

Regional Manager, West
 CELL PHONE / 505-975-0035
 EMAIL / JEoff@EvolutionEdges.com

JIM HILGENDORF

Regional Manager, Midwest
 CELL PHONE / 607-438-0676
 EMAIL / JimH@ChemungSupply.com

BRUCE NICHOLS

Regional Manager, East
 CELL PHONE / 802-770-3881
 EMAIL / Bruce@BuiltBlades.com

EMMA FRITTS

Sales Representative
 CELL PHONE / 607-379-9500
 EMAIL / EFritts@EvolutionEdges.com

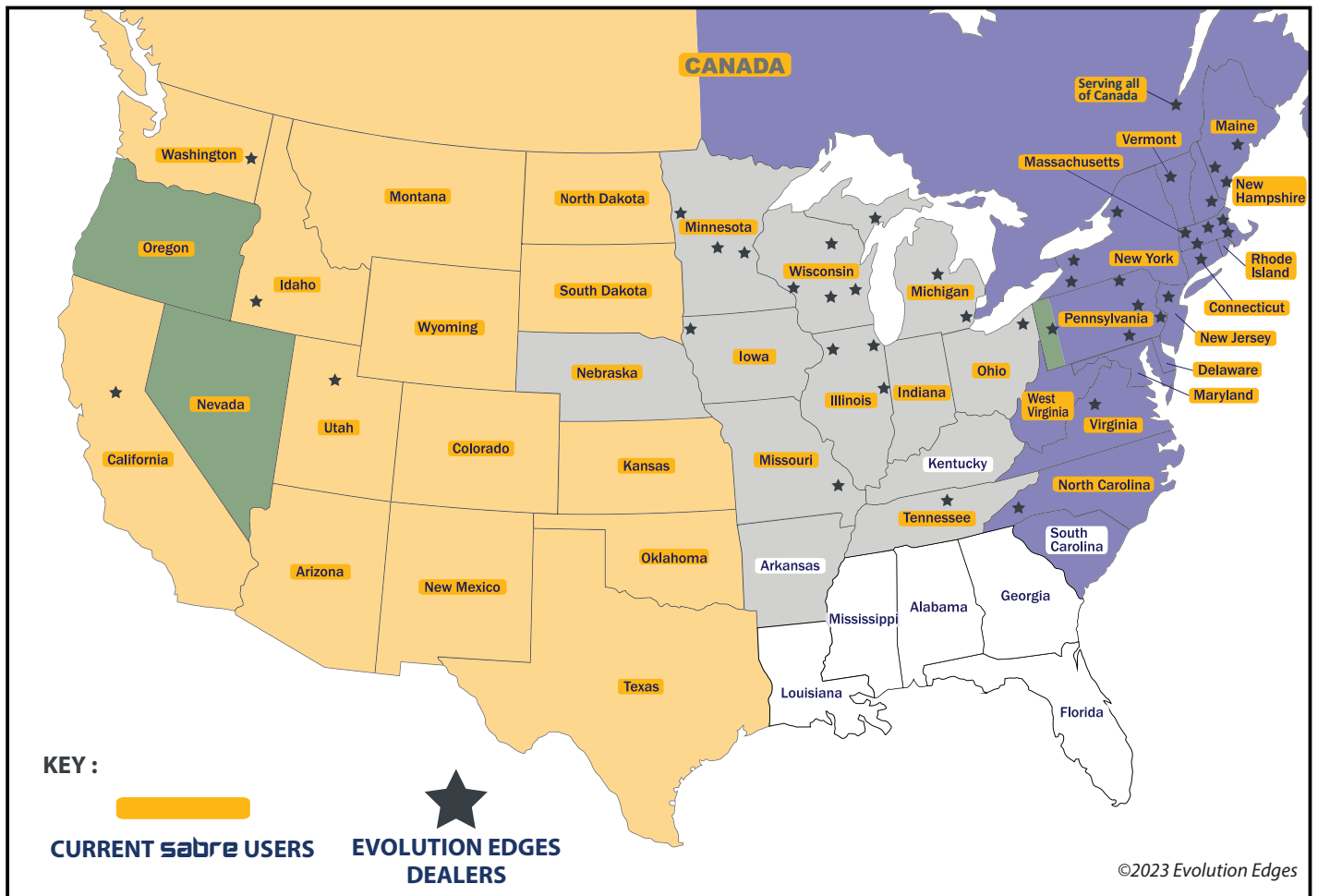

For information on your Local Dealer, contact info@builtblades.com

MAP AS OF JUNE 2023

COMPANY INFORMATION 3-4

About Us..... 3
 Cooperative Purchasing..... 4

SPECIALTY BLADES 5-15

sabre® Armored Carbide Snow Plow Blade..... 5-9
sabre® WING Carbide Snow Plow Blade..... 10
sabre® Stealth VST Blade Kit..... 11
 Blade Kits - General Information..... 12
 Reliant™ Flex Oscillating Kit..... 13-14
 Loader Cutting Edges..... 15

STANDARD BLADES 16

PICK UP BLADES 17-19

sabre® V-Blade Pick Up Kit..... 18-19

WEAR PARTS & ACCESSORIES 20-34

sabre® Wear Plates..... 20
sabre® Wear Plate Curb Guards..... 21
sabre® Curb Guards..... 22
 Curb Armor™ Curb Guards..... 23
 Additional Curb Guard Options..... 24
sabre® Plow Shoes..... 25
 Additional Plow Shoes..... 26-27
sabre® Nose Pieces..... 28
 Steel Nose Pieces..... 29
sabre® Multi-Tool..... 30
sabre® Plow Markers..... 31
sabre® Hardware..... 32
 Replacement Spreader Chains..... 33-34

PRODUCT LIST 35-48

sabre® Products..... 35-39
 Specialty, Carbide & Steel Blades..... 39-42
 Pick Up Blade Products..... 43-45
 Cast Shoes..... 46
 Steel Shoes..... 47-48
 Snow Pusher Shoes..... 48

ABOUT US

Evolution Edges was founded in 2009 in response to the snow plow industry's growing need for a streamlined parts-ordering process with fast delivery.

A Division of Chemung Supply Corporation, Evolution Edges is an authority on quality snowplow edges and wear parts for highway departments, municipalities and airports.

In November 2020, Evolution Edges acquired Built Blades, LLC and its U.S. patented Sabre® blade system. This acquisition has demonstrated Evolution Edges' dedication to continually improve snowplow cutting edge technology. In 2021 the Sabre® blade received its patent in Canada, as well.

With a strong commitment to innovation, our Evolution Edges products boost production and efficiency while reducing maintenance costs and repairs. We aim to provide quality parts that are Simple, Reliable, and Affordable.



EVOLUTION EDGES

Elmira, New York

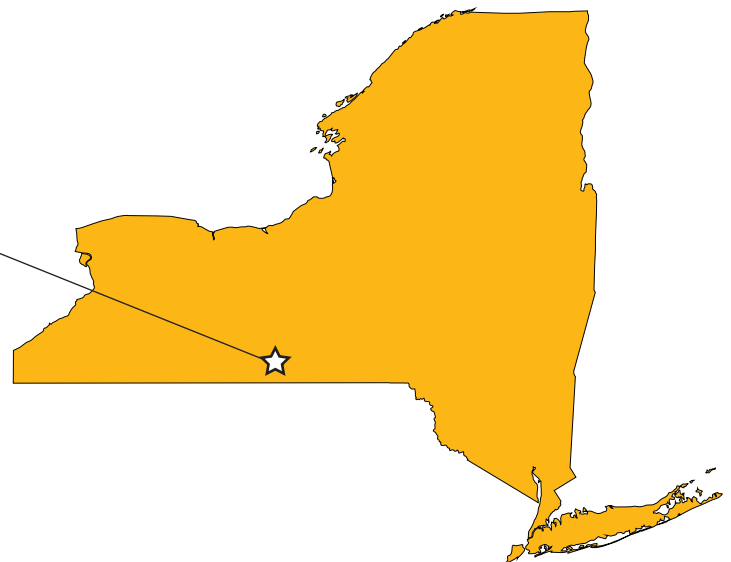

FAST DELIVERY

Evolution Edges is headquartered in Elmira, New York. Centrally located in the northeast, we are able to quickly and efficiently ship our essential products to customers all year round. Our large warehouses are dedicated solely to servicing our growing customer needs.

We pride ourselves on shipping products that are neatly-packed, and freight-cost-effective. Coordinated efforts with local freight carriers ensures fast, reliable, and affordable shipping.

COOPERATIVE PURCHASING

Time is money, and you'll save both every time you make a purchase.

Our Cooperative Purchasing contracts offer you the ability to purchase snow plow wear parts (cutting edges, plow shoes, curb guards, grader blades and sander chains) from us without having to duplicate the bidding process, because NASPO (National), Onondaga (New York), and COSTARS (Pennsylvania) have already done it for their members.

NASPO - National Purchasing

Evolution Edges' awarded contract #29533 with the National Association of State Procurement Officials (NASPO) ValuePoint for "Snow Plow Blade Cutting Edges" allows states and participating entities the ability to save time and money by streamlining the procurement process with cooperative purchasing.



For more information, visit: <https://www.naspovaluepoint.org/portfolio/snowplow-cutting-edges-2015-2022/chemung-supply-company-dba-evolution-edges/>

For those not familiar with NASPO ValuePoint's purchasing process, take these simple steps:

1. Become a NASPO ValuePoint Member

Those residing in Nevada and Utah can do so at: <http://www.naspovaluepoint.org/emarket-center/> Those residing elsewhere should contact their state's Central Procurement Office and ask for a login. An eMarket Center Administrator will then set up an account and provide login information. There are no fees to use the contracts, no commitment, and no obligation to purchase.

2. Contact Evolution Edges

Once you have a signed NASPO Participating Addendum, contact us and let us know you're interested in using the NASPO Valuepoint contract for Evolution Edges products – we'll do the rest!

ONONDAGA - New York Purchasing

Evolution Edges' awarded contract with Onondaga allows for the purchasing of our products without bidding. Please reference our Bid Number #0010660 when placing your order.



COSTARS - Pennsylvania Purchasing

For Pennsylvania customers only, we are now a member of Pennsylvania's cooperative purchasing program COSTARS. You can purchase our products with no need for bidding by using our contract number #4600016620.





ARMORED CARBIDE SNOWPLOW BLADE

KEY FEATURES

- A combination carbide blade with a built-in fully welded cover plate eliminates the need for full-length cover blades.
- Hardox® 450 impact resistant steel helps protect fragile tungsten carbide inserts.
- Hardox® 450 steel is nearly **2X More Abrasion-Resistant** and **3X More Impact-Resistant** than traditional cover blade steel.
- Bull-nose carbide inserts allow for a wide range of attack angles, spanning from 55°-90°.

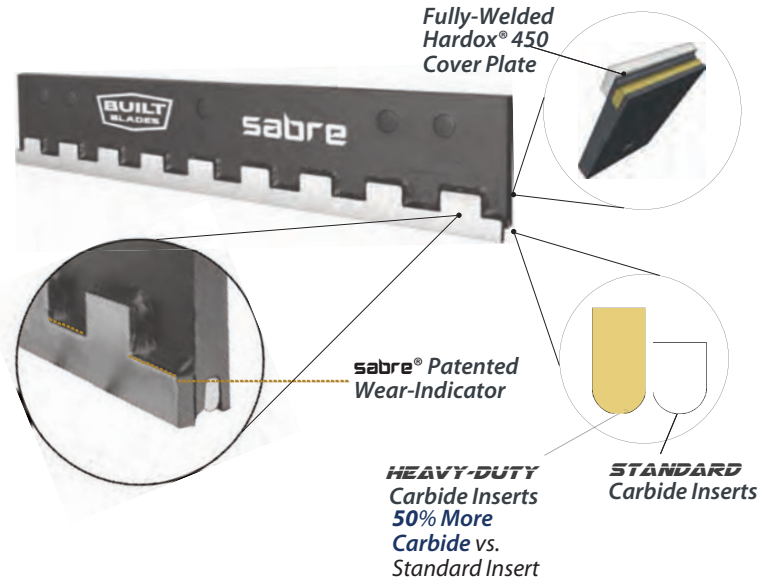

WEAR INDICATORS

- Built-in primary and secondary wear indicators quickly and safely demonstrate remaining blade life and help identify uneven wear points.
- Primary wear-indicators represent the top of the tungsten-carbide inserts, and will serve for most of the blade's service life.
- Secondary wear-indicators represent the maximum level of blade wear before the blade needs to be changed.
(Works on moldboards descending no more than 3" from bolt holes.)

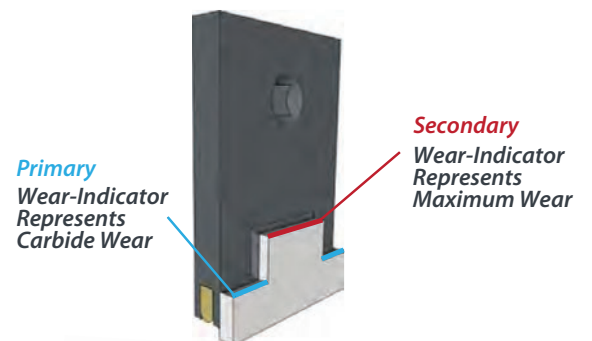

NON-INTERLOCKING BLADES

- 3 ft. and 4 ft. non-interlocking blade sections significantly reduce overall blade weight and waste.
- Less man power to ship, handle, and install.

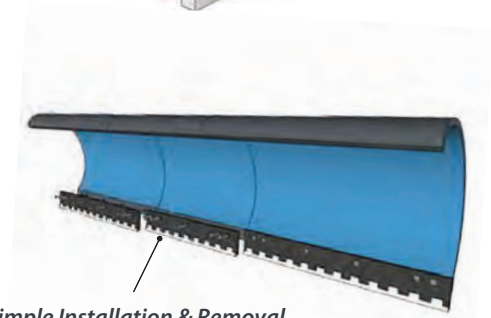

Simple Installation & Removal
Non-Interlocking Blades allow for use on sectional trip plows.



BLADE MATERIALS COMPARISON CHART

Carbide & Steel Cover Blade

vs.

sabre®

CARBIDE INSERT SPECIFICATIONS

Grade / Recycled Options

Thickness / 3/8"

Height / 5/8" (.625")

Shape / 25° Trapezoid

Attack Angle(s) / 65°

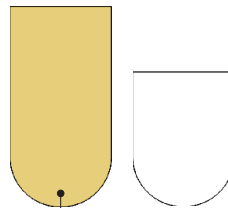
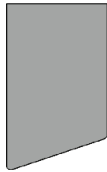

Grade / **Virgin Tungsten**

Width / 3/8"

Height / 3/4" + (.755") (HD)

/ 1/2" + (.5") (Standard)

Shape / Bull-Nose

Attack Angle(s) / 55° - 90°

• **50% More Carbide**
vs. Standard Insert

• **29% More Carbide**
vs. 5/8" Trapezoid Insert

COVER BLADE / COVER PLATE SPECIFICATIONS

Steel / 1084 Hot Rolled

Thickness / 5/8"

Height / 6"

Weight / 12.8 lbs./ft.

Attachment / Bolt-On

Wear Indicators / **NONE**

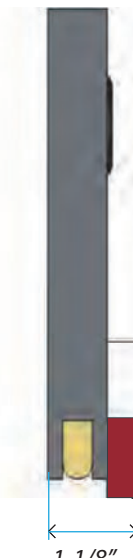

Steel / **Hardox® 450**

Thickness / 3/8"

Height / 2"

Weight / 1.91 lbs./ft.

Brinell Hardness / 2x Higher

Tensile Strength / 70% Higher

Yield Strength / 140% Higher

Attachment / **FULLY-WELDED**
Robotic Weld

Wear Indicators / **BUILT-IN**

• **18% Thinner**

For Improved Cutting Performance

For Full **sabre®** Specifications, email a request to info@builtblades.com

Carbide & Steel Cover Blade

vs.

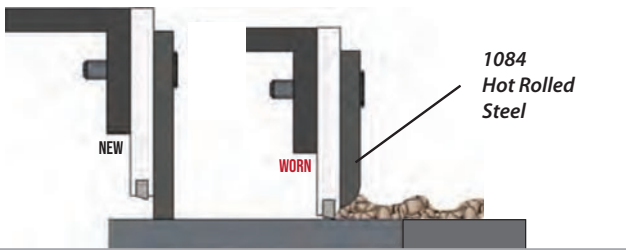

1084
Hot Rolled
Steel

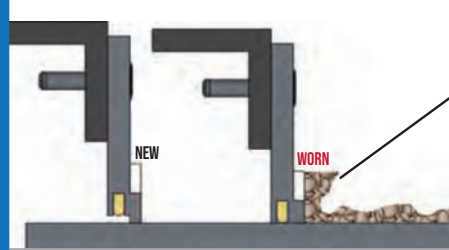

Hardox® 450
Heat-Treated Abrasion &
Impact Resistant Steel

2x Abrasion Resistance
3x Impact Strength
vs. 1084 hot rolled

CARBIDE PROTECTION



Approximate Removal / Installation Time
3 Worker @ 1 Hour = 3 Man Hours

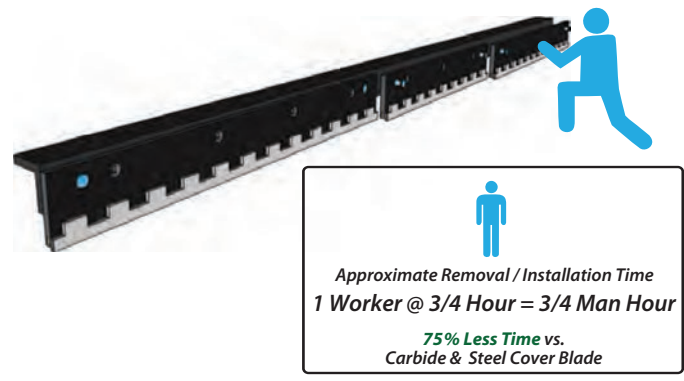

Approximate Removal / Installation Time
1 Worker @ 3/4 Hour = 3/4 Man Hour
75% Less Time vs.
Carbide & Steel Cover Blade

NOISE/VIASION



STORAGE

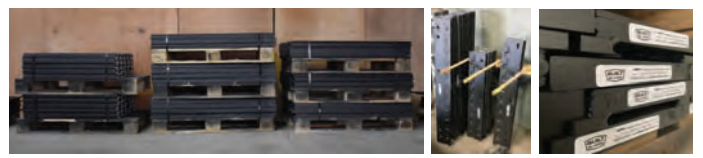

sabre® TESTIMONIALS

Testimonials submitted from Municipal Users
across 29 States, including these Departments:



"6,000 Plow Miles" (Sabre Heavy-Duty)
- State DOT Supervisor

"Only about 2,000 miles on so far, but seem to be
wearing much longer than our current carbides."
- State DOT Operator

"The Sabre blades are a good blade for interstate
plowing, they clean the road surface well."
- State DOT Supervisor

"They cut better than carbide & steel blade combo."
- State DOT Operator





COMMON MUNICIPAL ORDERING KITS

13 FT.

FRONT PLOW

RH WING PLOW

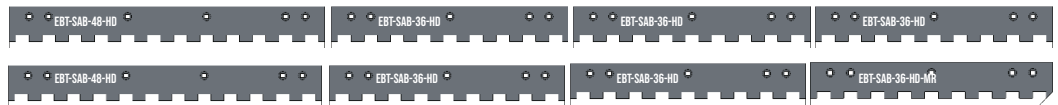

12 FT.

FRONT PLOW

RH WING PLOW

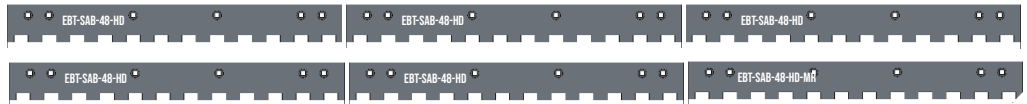

11 FT.

FRONT PLOW

RH WING PLOW

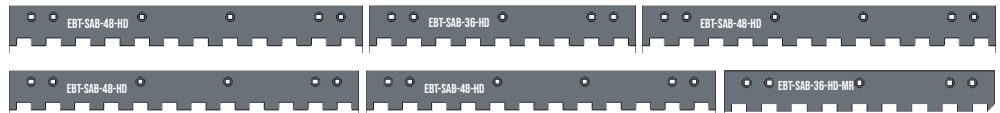

11 FT.

8" AASHTO



10 FT.

FRONT PLOW

RH WING PLOW

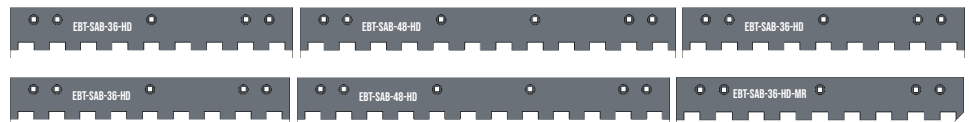

9 FT.

FRONT PLOW

RH WING PLOW

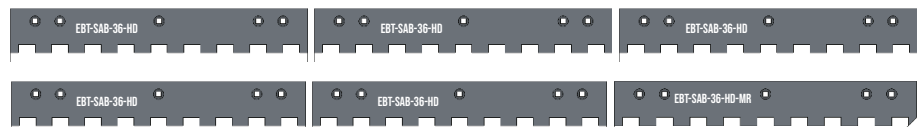



STANDARD / HEAVY-DUTY

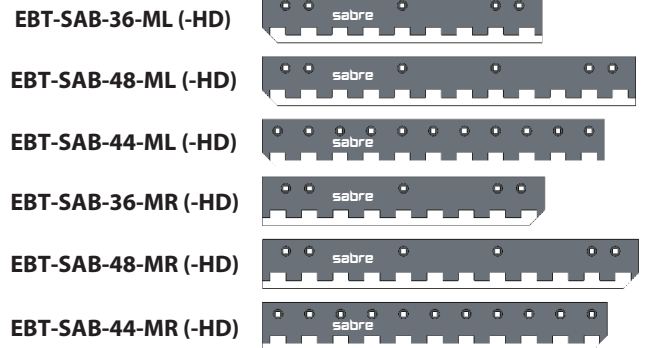
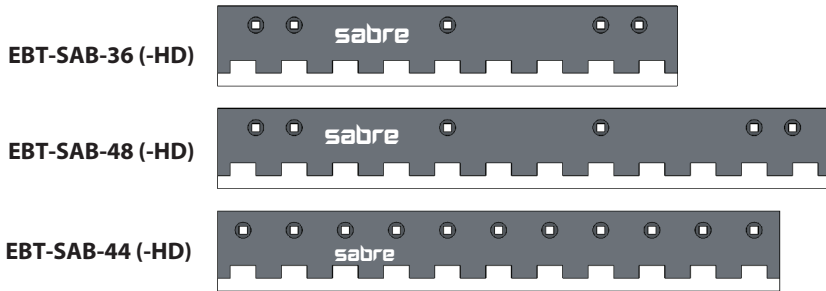

sabre® PATENTED STANDARD



PART # / Description

- EBT-SAB-36** / 36" Sabre / 3-3-12"
- EBT-SAB-48** / 48" Sabre / 3-3-12"
- EBT-SAB-44** / 44" Sabre / 2-4-4"

Mitered Options

- EBT-SAB-36-ML** / 36" Sabre / 3-3-12" / LH Mitre
- EBT-SAB-48-ML** / 48" Sabre / 3-3-12" / LH Mitre
- EBT-SAB-44-ML** / 44" Sabre / 2-4-4" / LH Mitre
- EBT-SAB-36-MR** / 36" Sabre / 3-3-12" / RH Mitre
- EBT-SAB-48-MR** / 48" Sabre / 3-3-12" / RH Mitre
- EBT-SAB-44-MR** / 44" Sabre / 2-4-4" / RH Mitre

sabre® PATENTED HEAVY-DUTY

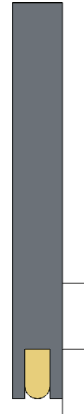

PART # / Description

- EBT-SAB-36-HD** / 36" Sabre_HD / 3-3-12"
- EBT-SAB-48-HD** / 48" Sabre_HD / 3-3-12"
- EBT-SAB-44-HD** / 44" Sabre_HD / 2-4-4"

Mitered Options

- EBT-SAB-36-HD-ML** / 36" Sabre_HD / 3-3-12" / LH Mitre
- EBT-SAB-48-HD-ML** / 48" Sabre_HD / 3-3-12" / LH Mitre
- EBT-SAB-44-HD-ML** / 44" Sabre_HD / 2-4-4" / LH Mitre
- EBT-SAB-36-HD-MR** / 36" Sabre_HD / 3-3-12" / RH Mitre
- EBT-SAB-48-HD-MR** / 48" Sabre_HD / 3-3-12" / RH Mitre
- EBT-SAB-44-HD-MR** / 44" Sabre_HD / 2-4-4" / RH Mitre



sabre® PATENTED UNDER-BODY

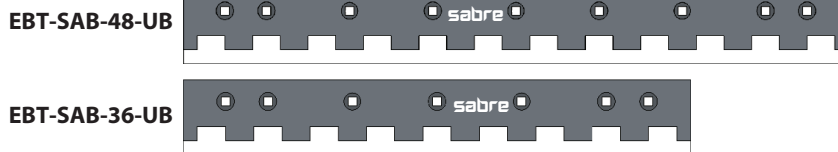

PART # / Description

- EBT-SAB-36-UB** / 36" Sabre_Underbody / 3-3-6"
- EBT-SAB-48-UB** / 48" Sabre_Underbody / 3-3-6"

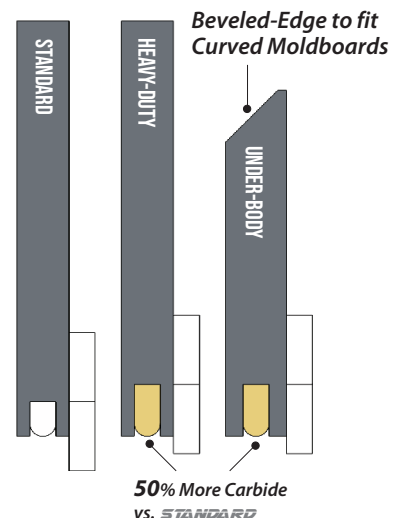

For detailed ordering information, please visit our website: www.BuiltBlades.com
 There you can view further information including Product Videos, installation techniques, comparison charts, and more.

sabre® WING

ARMORED CARBIDE SNOWPLOW BLADE

KEY FEATURES

- 3/4-Inch Hardox® 450 cover plates **2X the thickness of traditional Sabre blades**
- 1-Inch tall carbide inserts **33% more carbide than the Sabre HD 3/4 inch insert**

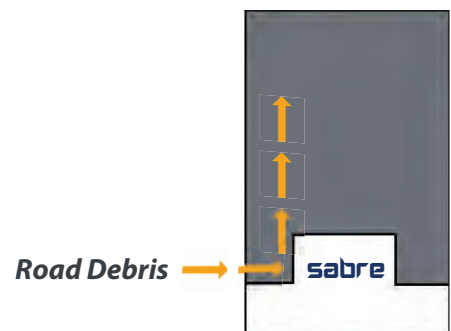
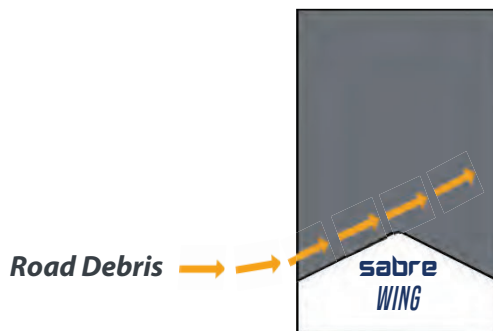
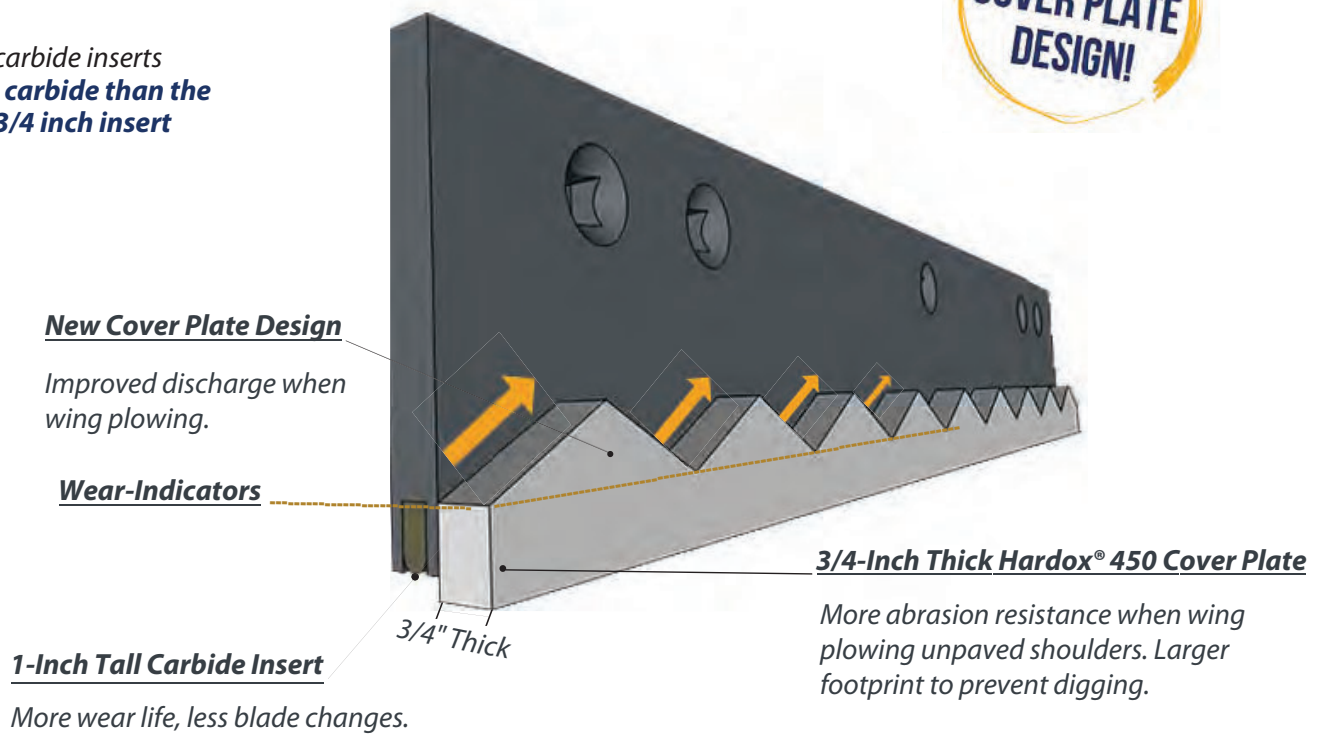

PART # / Description

EBT-SAB-36-WING / Sabre Wing Blade 3/4"/6"H/36"/ 3-3-12

EBT-SAB-48-WING / Sabre Wing Blade 3/4"/6"H/48"/ 3-3-12

sabre® STEALTH VST BLADE KIT

HOW THE BLADE COMPONENTS WORK

At the heart of the Sabre Stealth VST blade is our ultra-tough Sabre Heavy-Duty Armored Carbide Blade, proven, tested, and durable enough to handle virtually any plowing scenario. The Sabre_HD blade is encased in a high-quality rubber compound specifically engineered for use in colder temperatures and to withstand the conditions of municipal plowing. The patented bolt hole system on the Sabre Stealth blade incorporates a built-in clamp bar and cleverly designed bushings which allow the user to bolt on and torque the blade down without the need for extra parts and without restricting the blades ability to flex and absorb vibrations.

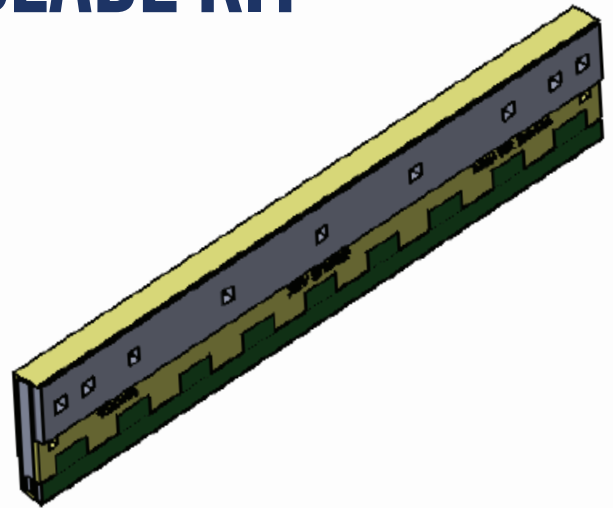

FEATURES & BENEFITS

- Simple 3' and 4' blade sections. Besides bolts, no extra parts or adapter blades needed for installation.
- Suppresses vibrations by 50%, helping reduce both driver fatigue and wear and tear on equipment.
- Fully-Armored Sabre_HD blade at the core for extreme durability.
- Incorporated Wear-Indicators to help operators better time blade changes.

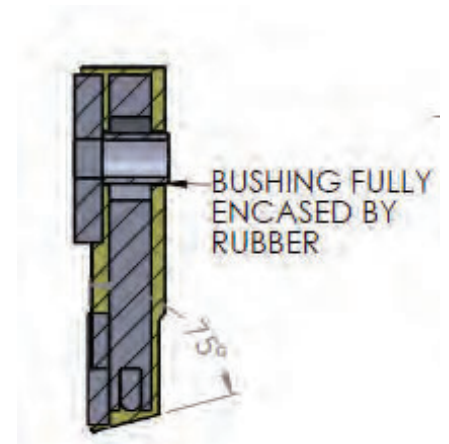

VST ENDURANCE™ KIT ORDERING INFORMATION - 3/4" CARBIDE INSERT



Available in 3 & 4 ft configurations.

PART # / Description

- EVST-SAB-3615** / Sabre Stealth VST - 3' Rubber Encased Sabre 1.5GA SHP
- EVST-SAB-4815** / Sabre Stealth VST - 4' Rubber Encased Sabre 1.5 GA SHP
- EVSTKIT-SAB-120** / Sabre Stealth VST 10' Kit - Encased Carbide & Cover Edge Kit
- EVSTKIT-SAB-132** / Sabre Stealth VST 11' Kit - Encased Carbide & Cover Edge Kit
- EVSTKIT-SAB-144** / Sabre Stealth VST 12' Kit - Encased Carbide & Cover Edge Kit

(KIT = BLADE ASSEMBLY + HEAVY DUTY CAST CARBIDE CURB GUARDS + HARDWARE BOX)

Sabre Stealth VST Kits include Evolution Edges Curb Armor™ curb guard systems. See page 23 for more information.

EVOLUTION EDGES BLADE KITS

Ordering Evolution Edges blade kits have become the preferred method for many of our customers, and can be done with ease by ordering through just one part number. Save yourself time when ordering and rest assured that you will have the correct blades, curb guards, and hardware, all packaged together neatly inside one kit.

Our blade kits ship to you inside wooden shipping crates that are easy to store and handle. Each crate includes a weather resistant crate cover to accommodate both indoor and outdoor storage. These crates are also designed for mobility in mind. With the use of a hand pallet jack, crates can easily be moved or stacked. Each shipping crate includes a complete hardware kit.



Our custom crates are available for:

- Reliant™ Carbide Blade Kit (a JOMA Alternative)
- Sabre VST Rubber-Encased Blade Kits



Through a partnership with our local not-for-profit organization Capabilities in Elmira, New York, our hardware kit assembly process has empowered individuals with disabilities the rewarding opportunity to be part of our packaging process.



STANDARD FEATURE WITH ALL BLADE KITS!

CURB ARMOR™ CAST CARBIDE CURB GUARD (WEAR PLATE INCLUDED)

Evolution Edges blade kits include our Curb Armor™ curb guard, made of a continuous molded piece of special formulated carbide with one of the longest trailing edges offered on the market today.

Specifications:

- Heavy Duty Carbide Cast Curb Guard
- Proprietary hard surfacing weldment of 1/2" on curb guard facing
- Reinforced bottom wear plate measuring 23.5" in length for greater longevity
- 1.0 inch thickness, allowing for double the amount of contact with the road
- Continuously rounded corners to minimize snow spray and stone fragments from entering the opposing lane

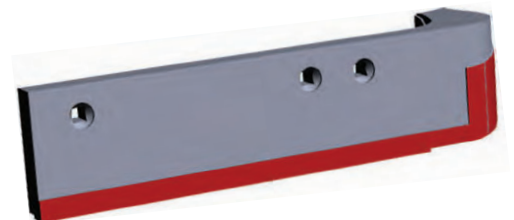

PART # / Description

- EGRD-PWRFLEX-L** / Curb Armor 1x6x21 Left - Heavy Duty Cast Carbide Curb Guard
- EGRD-PWRFLEX-R** / Curb Armor 1x6x21 Right - Heavy Duty Cast Carbide Curb Guard
- EGRD-PWRFLEX-S** / Curb Armor 1x6x22 Straight - Heavy Duty Cast Carbide Curb

RELIANT™ FLEX OSCILLATING KIT

(JOMA BLADE ALTERNATIVE)

KEY FEATURES

- Improved strength and extended wear life over that of standard carbide blades.
- A flex oscillating design with tungsten carbide inserts brazed into steel segments and encased in rubber
- Ships in a wood crate that is easy to store, stack and handle.
- Comes with a complete hardware kit.
- Curb Armor™ cast carbide curb guards included.



Reliant™ is a JOMA Alternative. JOMA® is a registered trademark, any reference to this mark is solely for functional or descriptive purposes, for reference only, and are not that of the respective manufacture.

RELIANT™ KIT ORDERING INFORMATION

PART # / Description

EFLEXXKIT- 8'SHP / 8 ft Reliant - Full Kit (Formerly TXS) - (4', 4')

EFLEXXKIT- 9'SHP / 9 ft Reliant - Full Kit (Formerly TXS) - (3', 3', 3')

EFLEXXKIT-10'SHP / 10 ft Reliant - Full Kit (Formerly TXS) - (3', 3', 4')

EFLEXXKIT-11'SHP / 11 ft Reliant - Full Kit (Formerly TXS) - (3', 4', 4')

EFLEXXKIT-12'SHP / 12 ft Reliant - Full Kit (Formerly TXS) - (4', 4', 4')

EFLEXXKIT-14'SHP / 14 ft Reliant - Full Kit (Formerly TXS) - (4', 4', 3', 3')

EFLEXXKIT- 8'REPLKT / 8 ft Reliant - Replacement Kit (Formerly TXS) - (4', 4')

EFLEXXKIT- 9'REPLKT / 9 ft Reliant - Replacement Kit (Formerly TXS) - (3', 3', 3')

EFLEXXKIT-10'REPLKT / 10 ft Reliant - Replacement Kit (Formerly TXS) - (3', 3', 4')

EFLEXXKIT-11'REPLKT / 11 ft Reliant - Replacement Kit (Formerly TXS) - (3', 4', 4')

EFLEXXKIT-12'REPLKT / 12 ft Reliant - Replacement Kit (Formerly TXS) - (4', 4', 4')

EFLEXXKIT-14'REPLKT / 14 ft Reliant - Replacement Kit (Formerly TXS) - (4', 4', 3', 3')

(KIT = BLADE ASSEMBLY + HEAVY DUTY CAST CARBIDE CURB GUARDS + HARDWARE BOX)

RELIANT™ Oscillating Flex Kits include Evolution Edges Curb Armor™ curb guard systems. See page 23 for more information.

CARBIDE INSERTS
Improved Strength
Longer Wear Life

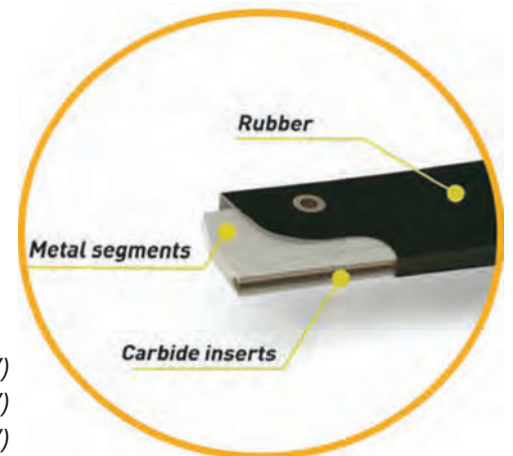

RELIANT™ KIT ASSEMBLY

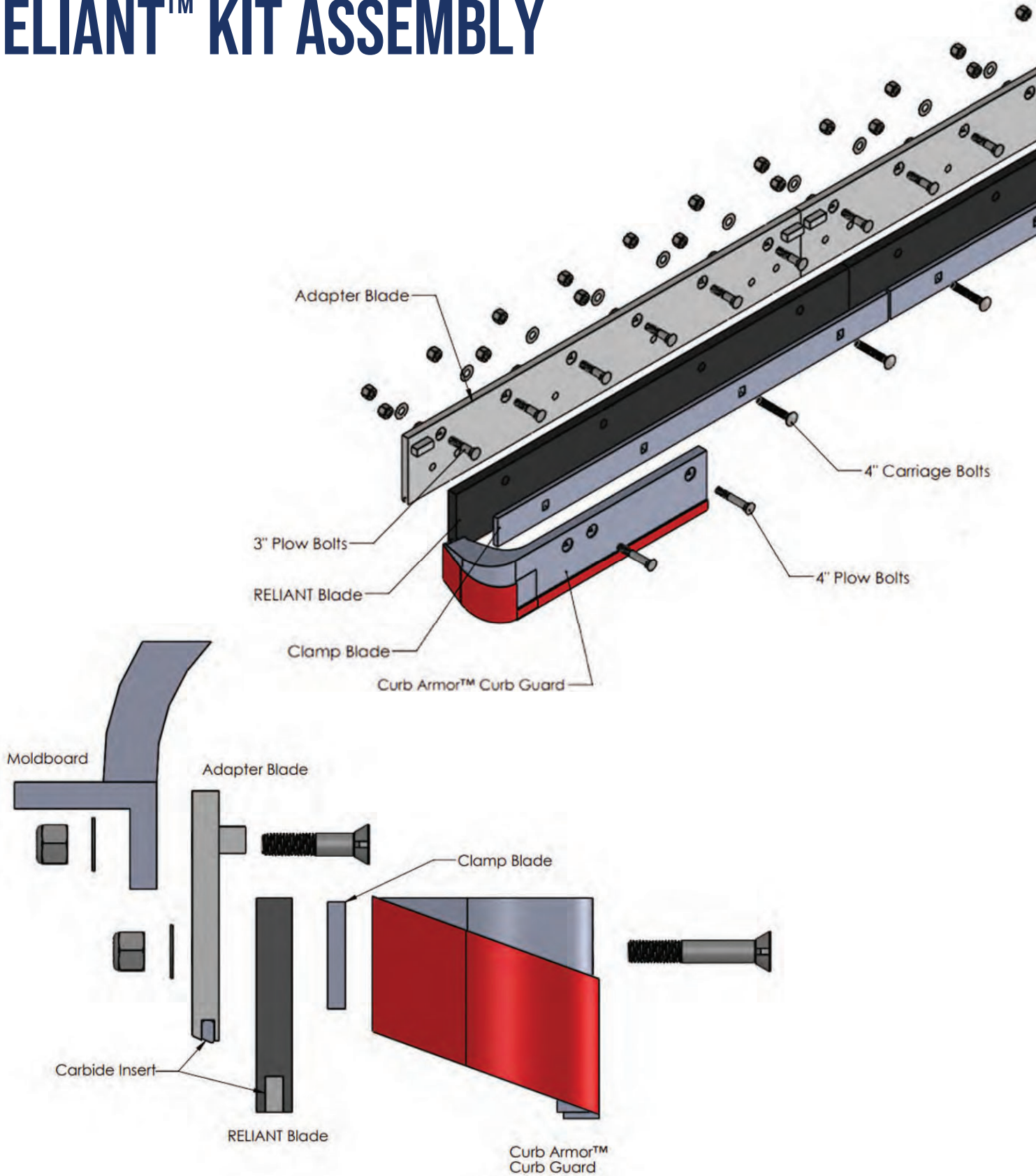

LOADER CUTTING EDGES

FOR ALL MAKES AND MODELS OF WHEEL LOADERS

A WIDE RANGE OF BOLT ON AND WELD ON CUTTING EDGES ARE AVAILABLE

- *Single bevel weld on cutting edges available in flat and half arrow styles.*
- *Double bevel bolt on edges available in multiple widths and thickness to suit your needs.*

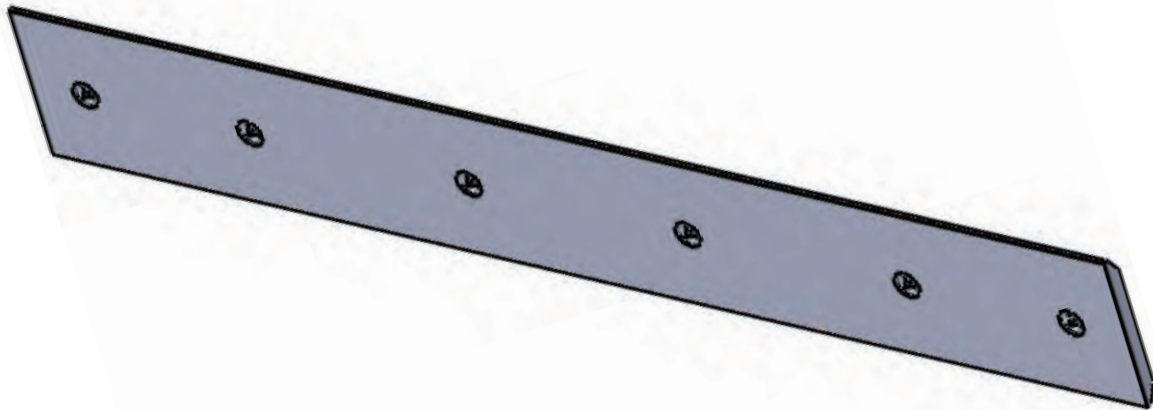

Loaders are the most varied product we offer. Each equipment manufacturer has its own system and spacing, with spacing varying for different sized models across a given manufacturers offering. This means edges are unique for almost each and every manufacturer and model.

Bolt on loader edges and segments have the most options available and are some of our most often customized products. Because there is very little interference on the bottom of a bucket, there is an almost endless possibility for customizations.

STANDARD BLADES

A VARIETY OF OPTIONS TO SUIT YOUR NEEDS

In addition to our specialty blade kits, we manufacture an extensive line of replacement standard blades to suit the needs of your plowing. For winter, we inventory **abrasion-resistant steel, carbide, and rubber cutting edges** for all types of snow plow equipment.

For spring and summer, we inventory replacement edges for most graders. We also stock or have immediate access to scarifier blades and related parts, bolt-on or weld-on edges for loads, dozers, and other earth-moving equipment.

EPBTPSQA-20401 / Steel Blade

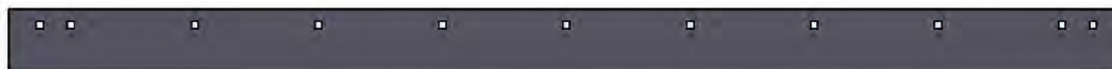

ECBTPSCA-21360 / Carbide Blade

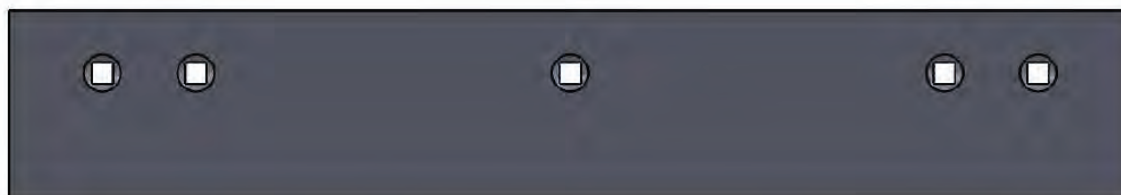

ERBL10A00000002 / Rubber Blade



EBLGRD00047 / Grader Blade

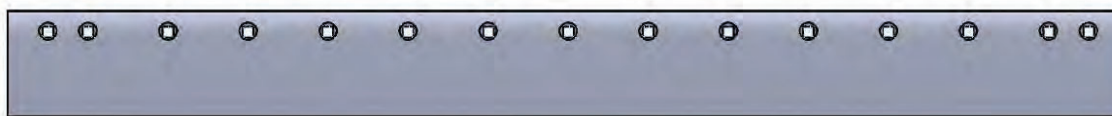

PICK-UP BLADES

MANUFACTURING OVER 400 PICK-UP BLADES

We have custom capabilities to manufacture over **400** combinations of pick-up blades (steel, carbide or rubber) for your V-Plow, Straight Plow, or Rear Mounted Drag Plow. If you don't see the right blade for you listed, contact us to discuss how we're certain we can meet your needs through our large variety of offerings.



Here's just one example of a V-Plow from our 400+ hole patterns:

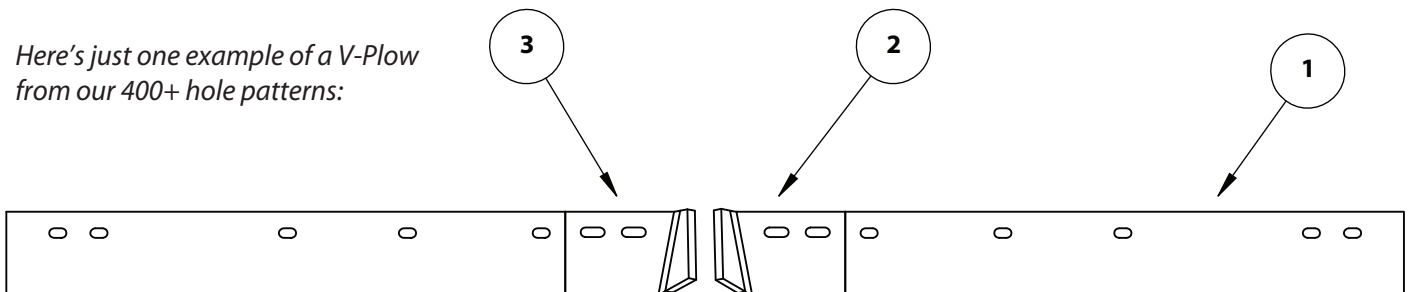

ITEM #	PART NUMBER	DESCRIPTION	QTY.
1	EPUKTPOVE-00005-1	5/8x6x40.75" EDGE	2
2	EPU-EXTV-R	EXT-V CENTERPIECE RIGHT	1
3	EPU-EXTV-L	EXT-V CENTERPIECE LEFT	1

sabre® V-BLADE PICK-UP KIT

KEY FEATURES

- The Sabre® V-Blade kits are designed for simple bolt-on replacement, and built for municipal and heavy commercial plowing applications.
- Tungsten-Carbide inserts provide extended wear life up to 10:1 over OEM Steel.
- Impact-sensitive carbide inserts are protected by the Sabre®'s lightweight full welded Hardox® 450 cover plate.



KIT ORDERING INFORMATION

PART # / Description

EBT-SVB-86 / 8'6" Sabre-V Blade Kit

EBT-SVB-96 / 9'6" Sabre V-Blade Kit

EBT-SVB-106 / 10'6" Sabre V-Blade Kit

*BOSS V-Blade Kits Available Upon Request

V-BLADE KIT PARTS:



Carbide Inserts

sabre® Fully-Welded Hardox® 450 Cover Plate

Hardox® 450 Armored Nose-Pieces

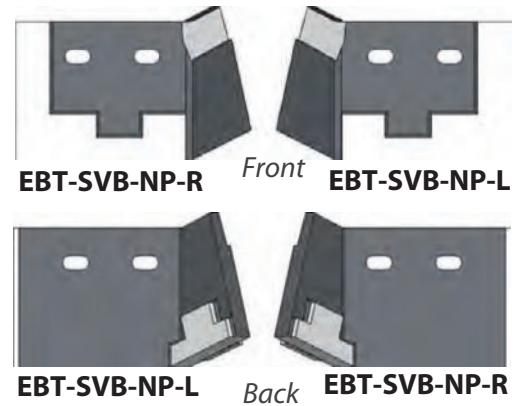

Included Grade 8 Hardware

V-BLADE WEAR PARTS

Upgrade an OEM steel blade with available **sabre®** V Wear Parts.

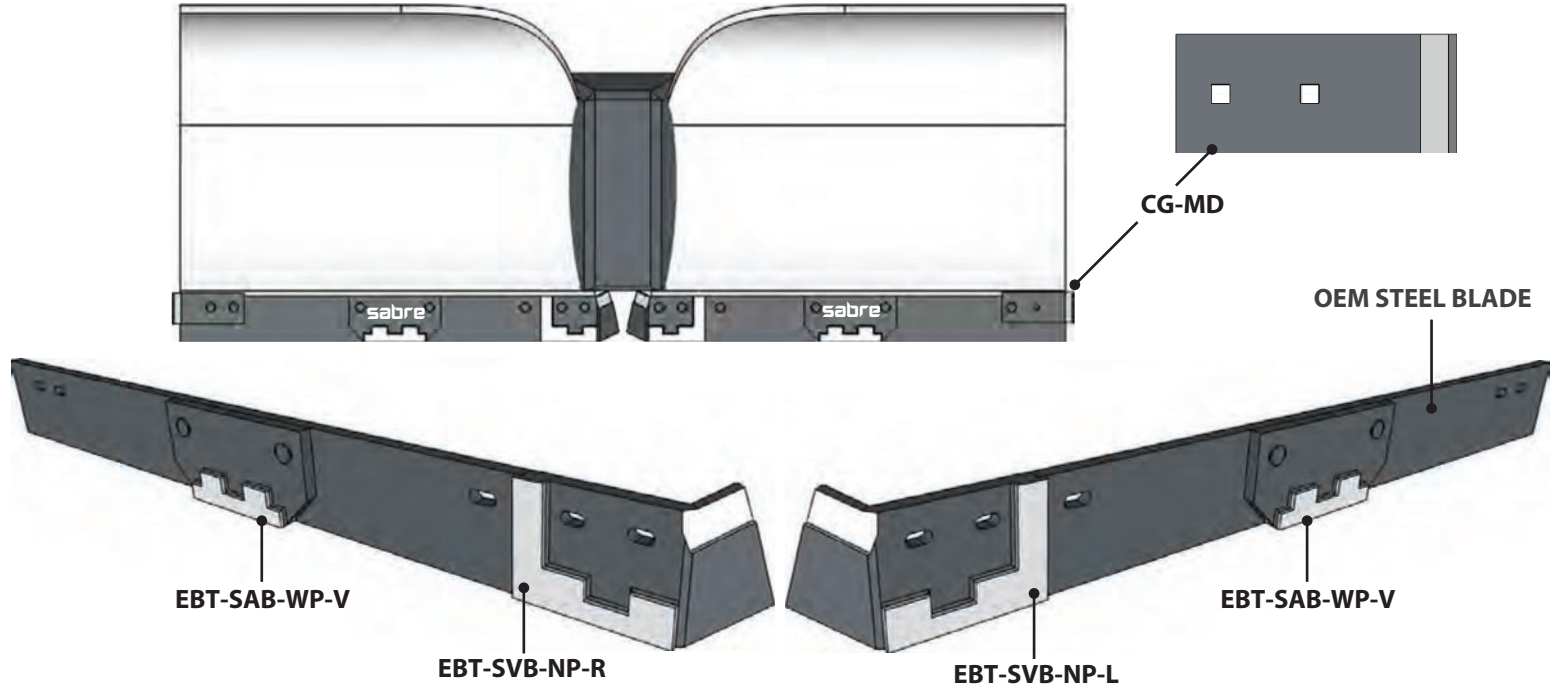

INDIVIDUAL PARTS ORDERING INFORMATION

PART # / Description

- EBT-SVB-NP-R** / Sabre_V Nose Piece / Right
- EBT-SVB-NP-L** / Sabre_V Nose Piece / Left
- EBT-SVB-NP-R-C** / Sabre_V Carbide Nose Piece / Right
- EBT-SVB-NP-L-C** / Sabre_V Carbide Nose Piece / Left
- EBT-SVB-106-W** / (2) 6" Sabre Wing Pieces + 9'6" = 10'6"
- EBT-SAB-WP-V** / 12" Sabre_V Blade Wear Plate
- EBT-SVB-86-L** / 8'6" Sabre_V Blade / Left
- EBT-SVB-86-R** / 8'6" Sabre_V Blade / Right
- EBT-SVB-96-R** / 9'6" Sabre_V Blade / Right
- EBT-SVB-96-L** / 9'6" Sabre_V Blade / Left
- EBT-WK-VB** / V-Blade Hardware Kit (14x Bolts, Nuts, Washers)

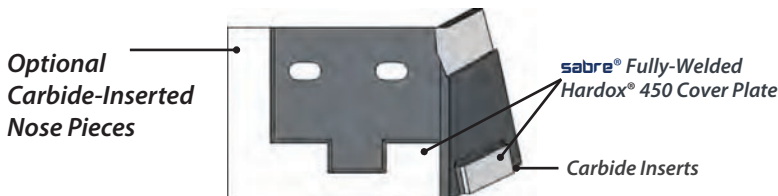
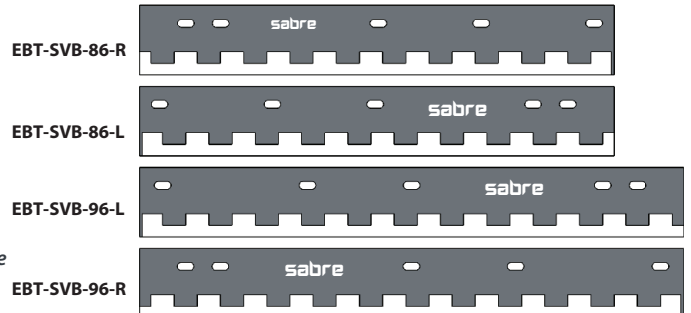
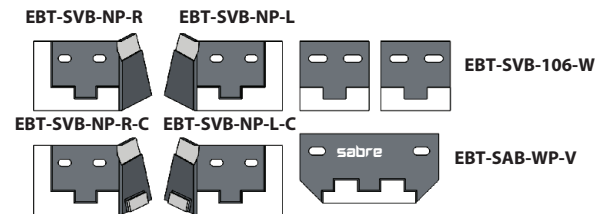

sabre® WEAR PLATES

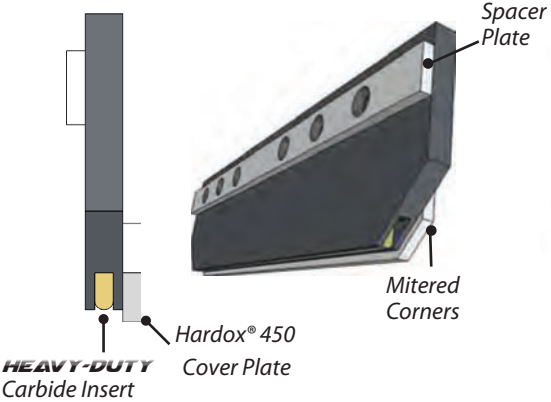

LOW ANGLE



HIGH ANGLE



WEAR PLATE ORDERING INFORMATION

12" AASHTO PUNCH

PART # / Description

EBT-SAB-WP-24-L / 24" Sabre Wear Plate / Low Angle

EBT-SAB-WP-24-H / 24" Sabre Wear Plate / High Angle

EBT-SAB-WP-L / 18" Sabre Wear Plate / Low Angle

EBT-SAB-WP-H / 18" Sabre Wear Plate / Low Angle

8" AASHTO PUNCH

PART # / Description

EBT-SAB-WP-24-8-L / 24" Sabre Wear Plate / Low Angle / 8"

EBT-SAB-WP-24-8-H / 24" Sabre Wear Plate / High Angle / 8"

EBT-SAB-WP-8-H / 18" Sabre Wear Plate / High Angle / 8"

*8" Low Angle Available Upon Request

CUSTOM WEAR PLATES

PART # / Description

EBT-SAB-WP-UB / 18" Sabre Underbody Wear Plate / -22° Angle

EBT-SAB-WP-BOSS / 18" Sabre Wear Plate / 12" Slotted Holes

EBT-SAB-WP-V / 12" Sabre Wear Plate / for Sabre_V

*Custom Wear Plates Available Upon Request

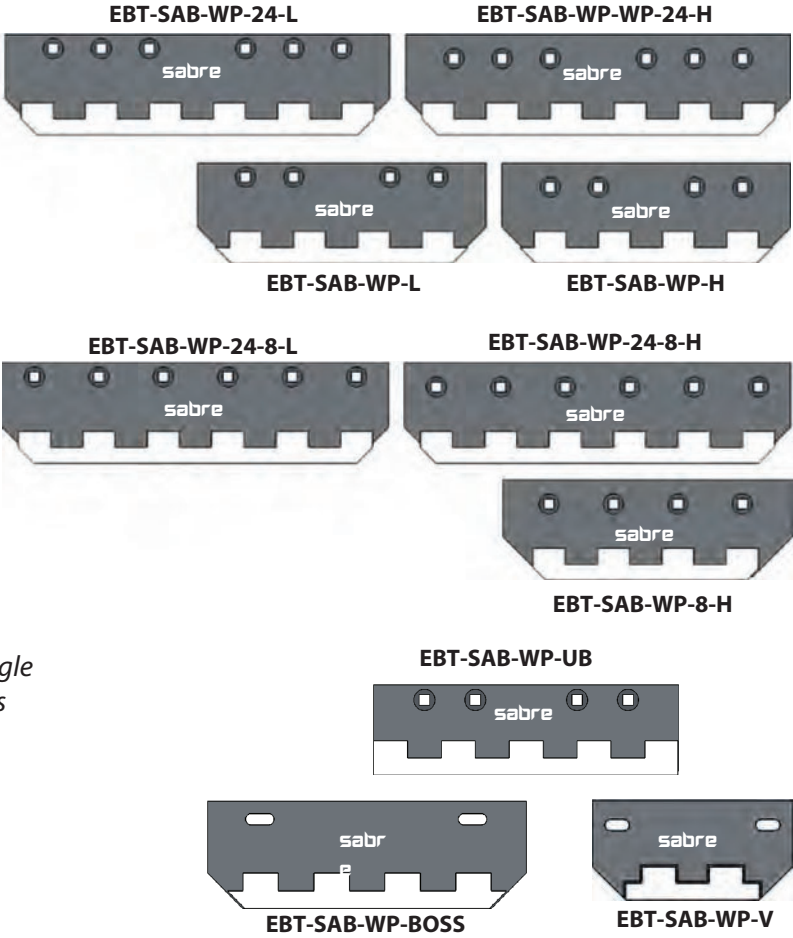

sabre® WEAR PLATE CURB GUARDS

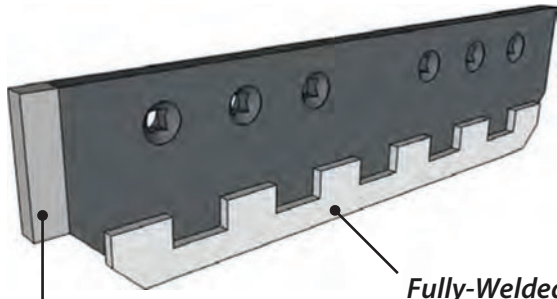

Fully-Welded Carbide Wear Bar

Fully-Welded Hardox® 450 Cover Plate

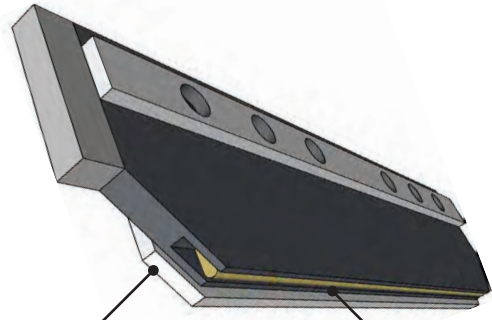

Mitered Corners

HEAVY-DUTY Carbide Inserts

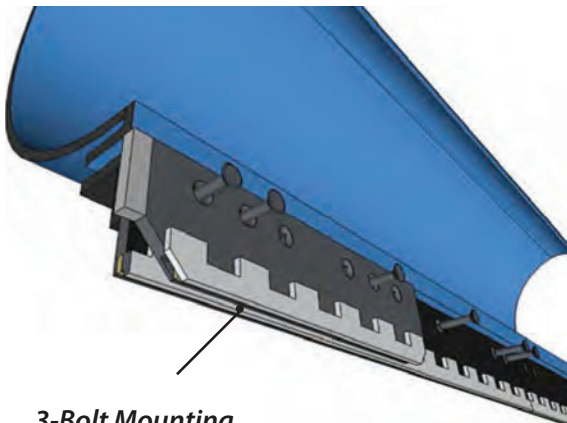

3-Bolt Mounting

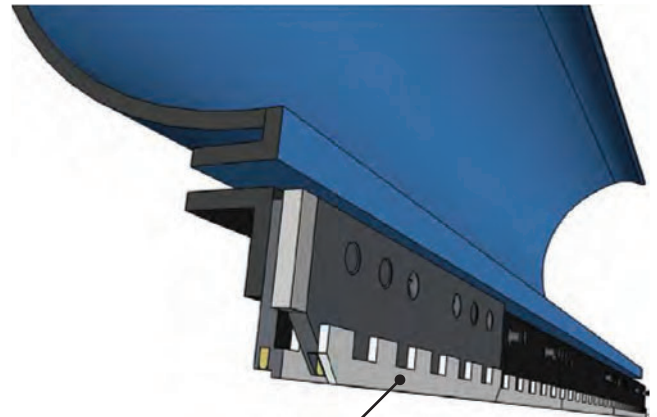

EBT-SAB-WP-CG-H-R

WEAR PLATE ORDERING INFORMATION

PART # / Description

EBT-SAB-WPCG-H-R

24" Sabre Wear Plate Curb Guard / High Angle / Right

EBT-SAB-WPCG-H-L

24" Sabre Wear Plate Curb Guard / High Angle / Left

EBT-SAB-WPCG-L-R

24" Sabre Wear Plate Curb Guard / Low Angle / Right

EBT-SAB-WPCG-L-L

24" Sabre Wear Plate Curb Guard / Low Angle / Left

* 8" AASHTO Punch Available Upon Request

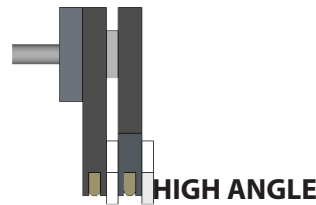

HIGH ANGLE

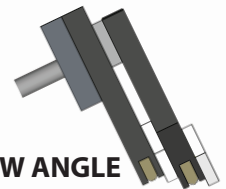

LOW ANGLE



EBT-SAB-WPCG-H-R

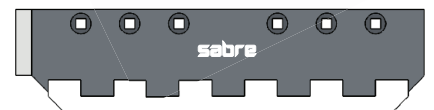

EBT-SAB-WPCG-L-R



EBT-SAB-WPCG-H-L

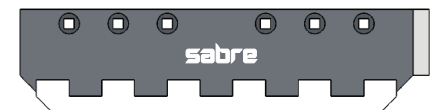

EBT-SAB-WPCG-L-L

sabre® CURB GUARDS

sabre® MEDIUM-DUTY CURB GUARD

A simple (2) bolt design that incorporates a fully-welded carbide wear bar for curb protection.

MEDIUM DUTY ORDERING INFORMATION

PART # / Description
EBT-CG-MD / Medium-Duty Curb Guard / 3-3"

(Works Left or Right)

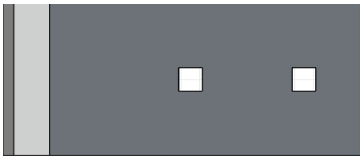

EBT-CG-MD

Works on V-Blades

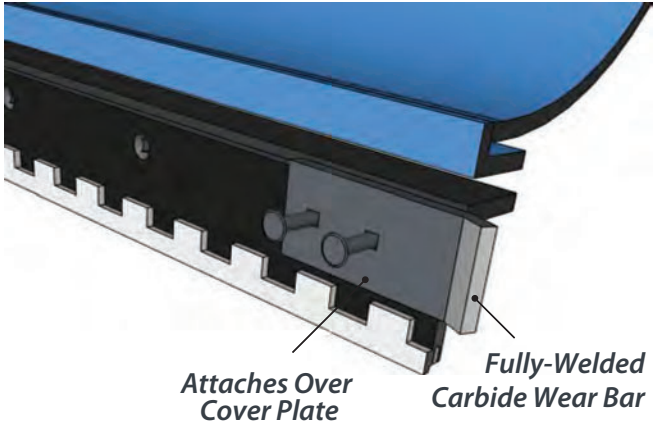

Attaches Over Cover Plate

Fully-Welded Carbide Wear Bar

sabre® HEAVY-DUTY CURB GUARD

A sturdy (3) bolt wrap-around design that features carbide hardfacing as a curb wear surface.



Carbide Hardfacing



Adapter Plate



Wrap-Around Protection

HEAVY-DUTY ORDERING INFORMATION

PART # / Description
EBT-CG-HD-R / Heavy-Duty Curb Guard/Right
EBT-CG-HD-L / Heavy-Duty Curb Guard/Left



EBT-CG-HD-R



EBT-CG-HD-L

*8" AASHTO Punch Available Upon Request

CURB ARMOR™ CURB GUARDS

CURB ARMOR™ CAST CARBIDE CURB GUARD (WEAR PLATE INCLUDED)

Evolution Edges blade kits include our Curb Armor™ curb guard, made of a continuous molded piece of special formulated carbide with one of the longest trailing edges offered on the market today.

SPECIFICATIONS:

- Heavy Duty Carbide Cast Curb Guard
- Proprietary hard surfacing weldment of 1/2" on curb guard facing
- Reinforced bottom wear plate measuring 23.5" in length for greater longevity
- 1.0 inch thickness, allowing for double the amount of contact with the road
- Continuously rounded corners to minimize snow spray and stone fragments from entering the opposing lane

CURB ARMOR™ ORDERING INFORMATION

PART # / Description

EGRD-PWRFLEX-L / Curb Armor 1x6x21 Left - Heavy Duty Cast Carbide Curb Guard

EGRD-PWRFLEX-R / Curb Armor 1x6x21 Right - Heavy Duty Cast Carbide Curb Guard

EGRD-PWRFLEX-S / Curb Armor 1x6x22 Straight - Heavy Duty Cast Carbide Curb



ADDITIONAL CURB GUARD OPTIONS

Curb Guards are a very popular request with our customers, as they add an additional level of protection to their snow plows. In addition to our Sabre® and Curb Armor™ Curb Guards, we have a variety of additional types:

TYPE		LENGTH (EA) STEEL			LENGTH (EA) STEEL W/CARBIDE INSERTS		
SERIES	DESCRIPTION	SHORT (10-15")	STANDARD (15-21")	LONG (22-24")	SHORT (10-15")	STANDARD (15-21")	LONG (22-24")
EGRD-1500	3/4X6" CURVED GUARD						
EGRD-1550	3/4X8" CURVED GUARD						
EGRD-1560	7/8X6" CURVED GUARD						
EGRD-1565	7/8X8" CURVED GUARD						
EGRD-1590	3/4X6" STRAIGHT GUARD						
EGRD-1595	3/4X8" STRAIGHT GUARD						
EGRD-PICK	7/8X6" STRAIGHT GUARD PICK						

EGRD-1500

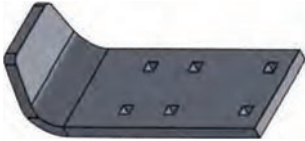

EGRD-1550

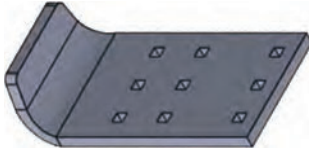

EGRD-1560

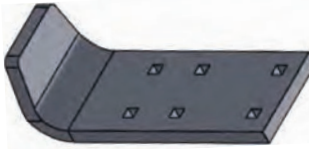

EGRD-1565

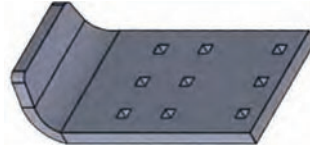

EGRD-1590



EGRD-1595



EGRD-PICK



OTHER OPTIONS

- *Hard-Facing*
(curb side, front face, or both)
- *Front Face*
- *Both*

sabre® PLOW SHOES

CARBIDE MOLDBOARD SHOES



Extra-Wide Carbide Inserts

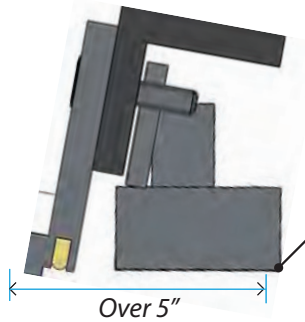

Adds Surface-Area to Cutting Edge

Over 5"

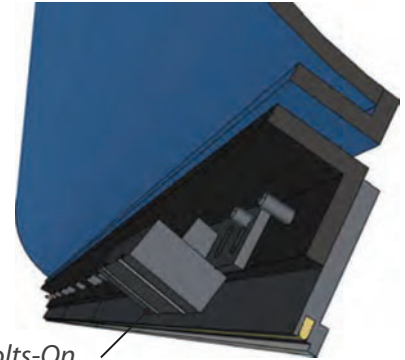

Bolts-On Behind Moldboard



Available in Multiple Angles

CARBIDE FRAME SHOES



Carbide Inserts Aligned with Travel Direction



Attaches to Plow Frame

ORDERING INFORMATION

PART # / Description

- EBT-CWS-55** / 55° Carbide Wear Shoe
- EBT-CWS-65** / 65° Carbide Wear Shoe
- EBT-CWS-80** / 80° Carbide Wear Shoe
- EBT-CWS-85** / 85° Carbide Wear Shoe

- EBT-CFS-UNI** / Universal Carbide Frame Shoe
- EBT-CFS-BOAT** / "Boat" Style Carbide Frame Shoe



EBT-CWS-55
EBT-CWS-65



EBT-CWS-80
EBT-CWS-85



EBT-CFS-UNI



EBT-CFS-BOAT

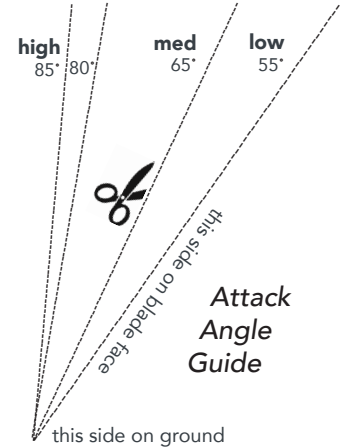

ADDITIONAL PLOW SHOES

STEEL WING SHOES

Steel Wing Shoe OST-400

Steel Wing Shoe
Compatible with 8" and 12" Centers



Steel Wing Shoe OST-410

Steel Wing Shoe: Same as OST-400
with 10° Offset Flange Compatible
with 8" and 12" Centers



Steel Wing Shoe OST-415

Steel Wing Shoe: Same as OST-400
with 15° Offset Flange Compatible
with 8" and 12" Centers



Steel Wing Shoe OST-425

Steel Wing Shoe: Same as OST-400
with 25° Offset Flange
Compatible with 8" and 12" Centers



Steel Wing Shoe OST-2400

Dual-base Steel Wing Shoe
Compatible with 8" and 12" Centers
Used on 8" Top-punched Blades



Steel Wing Shoe OST-2410

Dual-base Steel Wing Shoe:
Same as OST-2400 with 10° Offset Flange
Compatible with 8" and 12" Centers
Used on 8" Top-punched Blades



FRAME SHOE ADAPTERS

Frame Shoe Adapters OST-100

Flat Frame Shoe Bracket Used on
Viking Plows before 2001 4" x 10" Shaft



Frame Shoe Adapters OST-100N

Flat Frame Shoe Bracket Used on
Viking Plows after 2000 3" x 10" Shaft



Frame Shoe Adapters OST-110

Flat Frame Shoe Bracket Used on
Tenco Plows 3" x 15" Shaft

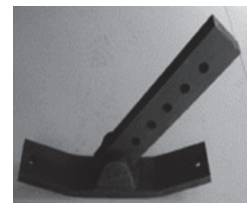

Frame Shoe Adapters OST-120

Flat Frame Shoe Bracket Used on
Frink/Everest Plows 3" x 15" Shaft

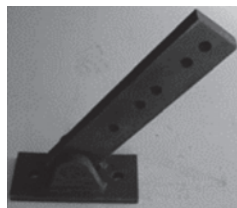

STEEL / CARBIDE FRAME SHOES

Steel Frame Shoe OST-900
 Flat Steel Frame Shoe Uses 3/4"
 Plow Bolts
 1- 3/4" x 8" x 14"



Carbide Frame Shoe OCS-100
 Carbide Flat Frame Shoe
 Uses OST-110, OST-100N or
 OST-120 Shoe Bracket



Carbide Frame Shoe OCS-910
 Carbide Boat Frame Shoe Uses
 OST-110 Shoe Bracket



STEEL MOLDBOARD SHOES

Steel Moldboard Shoe OST-600
 Steel Moldboard Shoe
 3/4" Base
 Compatible with 8" and 12" Centers



Steel Moldboard Shoe OST-605
 Steel Moldboard Shoe
 1" Base
 Compatible with 8" and 12" Centers



Steel Moldboard Shoe OST-610
 Cast Wing Shoe
 1-1/4" Base
 Compatible with 8" and 12" Centers



Steel Moldboard Shoe OST-610/60
 Steel Moldboard Shoe
 1/4" Base with 60° Angle
 Compatible with 8" and 12" Centers



Steel Moldboard Shoe OST-620, 620A
 Steel Moldboard Shoe
 Compatible with 8" and 12" Centers
 Optional Slots for Height Adjustment



Steel Moldboard Shoe OST-625 Steel
 Moldboard Shoe Flange has 15° Angle
 Compatible with 12" Centers



Steel Moldboard Shoe OST-635
 Steel Moldboard Shoe (Heavy Duty)
 Flange has 25° Angle
 Compatible with 8" and 12" Centers



Steel Moldboard Shoe OST-645
 Steel Moldboard Shoe
 1 - 1/4" Base
 Fits 8" Center-punched Blades



Steel Moldboard Shoe OST-660
 Steel Moldboard Shoe One Way,
 Fits 12" Centers



Steel Moldboard Shoe OST-675
 Steel Moldboard Shoe (Heavy
 Duty) One Way, Fits 12" Centers



Steel Moldboard Shoe OST-680
 Steel Moldboard Shoe (Heavy Duty)
 One Way, Fits 8" and 12" Blades



Steel Moldboard Shoe OST-2600
 Steel Moldboard Shoe - Double
 Optional 60° Angle
 Compatible with 8" and 12" Centers
 Used on 8" Top-punched Blades



sabre[®] NOSE PIECES

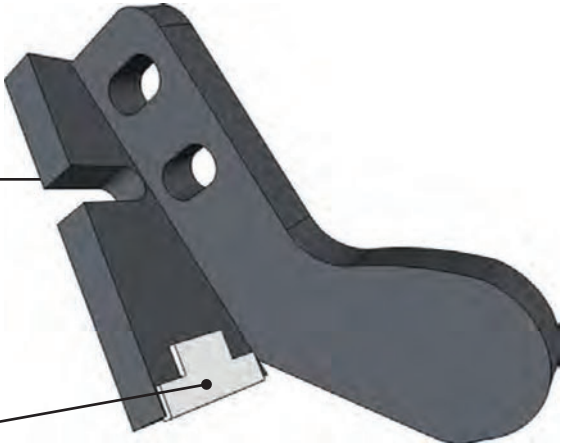
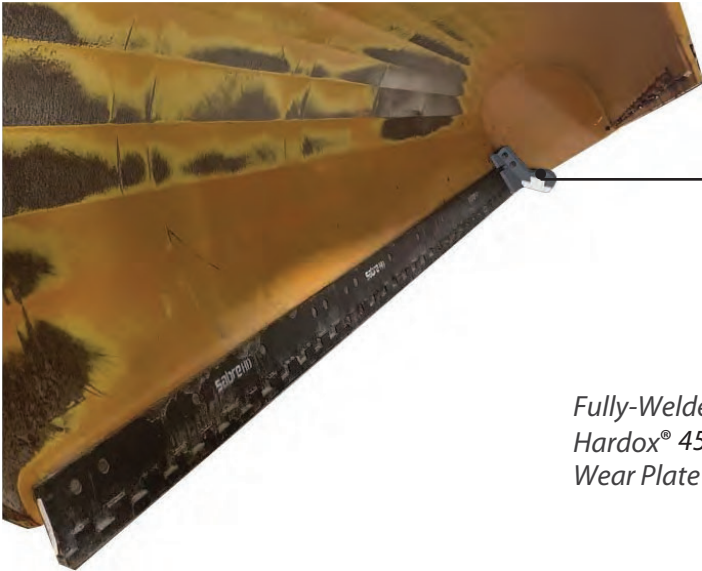

Fully-Welded
Hardox[®] 450
Wear Plate

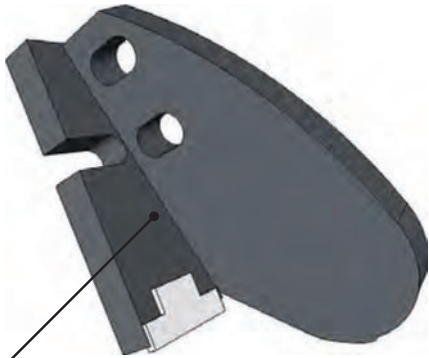
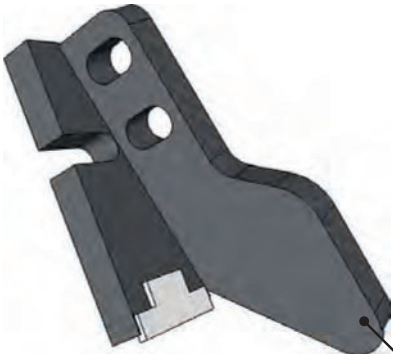

Options Available for
Popular Moldboards

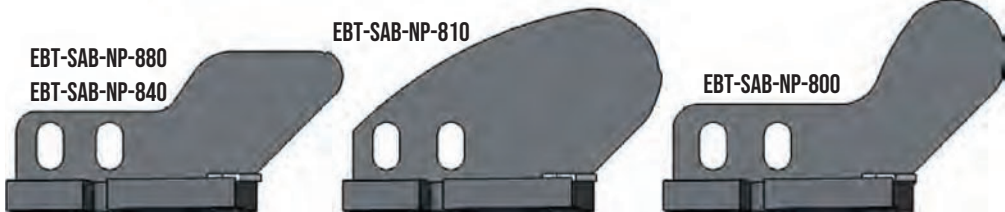

ORDERING INFORMATION

- PART # / Description**
- EBT-SAB-NP-880 / Sabre Nose Piece / Everest**
- EBT-SAB-NP-840 / Sabre Nose Piece / Tenco (Post 1984)**
- EBT-SAB-NP-810 / Sabre Nose Piece / Frink / Henderson**
- EBT-SAB-NP-800 / Sabre Nose Piece / Viking (Post 2000)**

*** FOR CUSTOM SABRE NOSE PIECE REQUESTS,
PLEASE E-MAIL: INFO@BUILTBLADES.COM**

STEEL NOSE PIECES

Steel Nosepiece OST-700

Steel Nosepiece Used on
Frink Models 8"
Top-punched Blades



Steel Nosepiece OST-750

Steel Nosepiece (Heavy
Duty) Used on Frink Models
8" Top-punched Blades



Steel Nosepiece OST-780

Steel Nosepiece
Used on LaRoche Models
8" Top-punched Blades



Steel Nosepiece OST-800

Steel Nosepiece
Used on Viking Plows, Pre-2001



Steel Nosepiece OST-800N

Steel Nosepiece
Used on Viking Plows, Post-2000



Steel Nosepiece OST-810

Steel Nosepiece
Used on Frink Model #640 Plows



Steel Nosepiece OST-820

Steel Nosepiece
Used on Tenco Plows,
Pre-1985



Steel Nosepiece OST-830

Steel Nosepiece (Heavy Duty)
Used on Tenco Plows, Pre-1985
8" Top-punched Blades



Steel Nosepiece OST-840

Steel Nosepiece
Used on Tenco Plows,
Post-1984



Steel Nosepiece OST-850

Steel Nosepieces (Heavy Duty)
Used on Viking Plows
8" Top-punched Blades



Steel Nosepiece OST-880

Steel Nosepiece
Used on Everest Plows



Steel Nosepiece OST-890

Steel Nosepiece (Heavy Duty)
Used on Everest Plows
8" Top-punched Blades



sabre[®] MULTITOOL

NEW PRODUCT!

A MULTI-FUNCTION TOOL WITH SEVERAL KEY USES

- *Left Curb Guard - High Mount*
- *Left Curb Guard - Low Mount*
- *Right Curb Guard - High Mount*
- *Right Curb Guard - Low Mount*
- *Sabre Wear Plate*



EXAMPLES OF THE MULTI-TOOL INSTALLED:

Curb Guard - High Mount

Curb Guard - Low Mount

Sabre Wear Plate

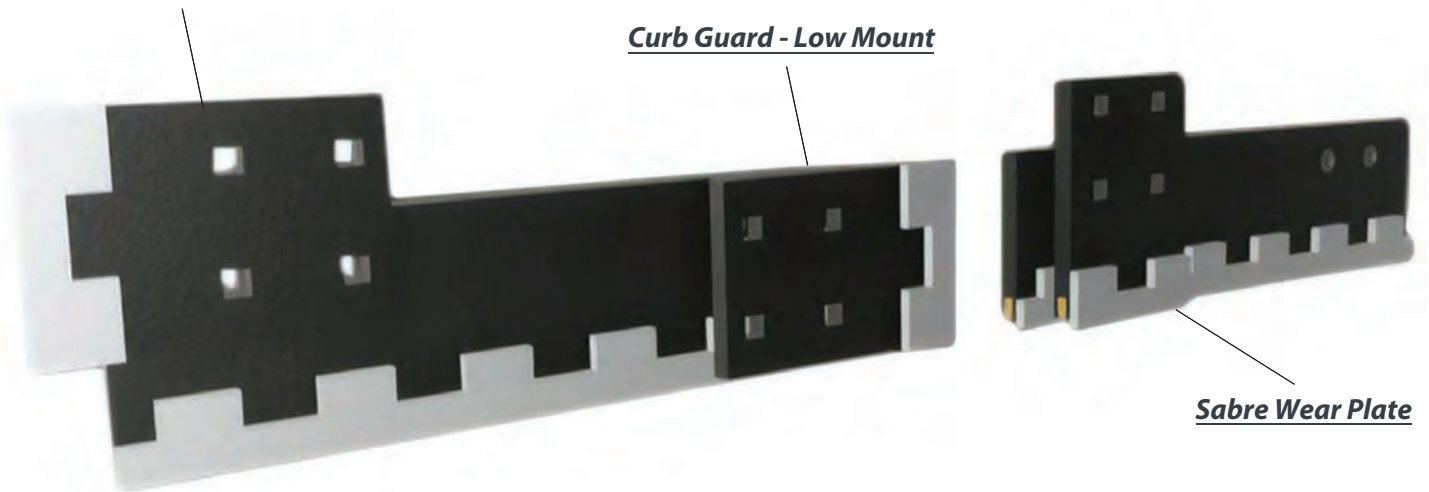

ORDERING INFORMATION

PART # / Description

EBT-SAB-MULTITOOL / Sabre Multitool 3/4x8x6 5/8 Bolt

PLOW MARKERS

 **100%**
Made In USA

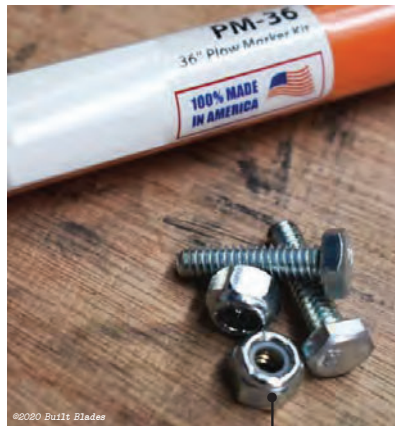
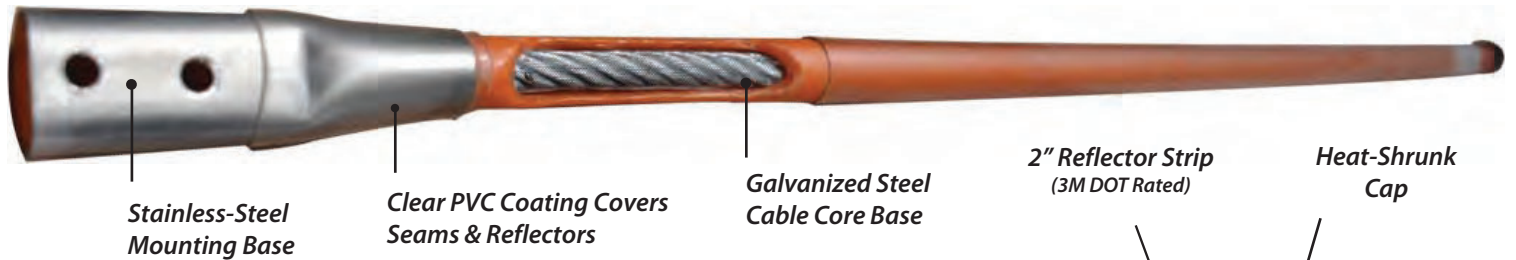

Included Stainless-Steel Mounting Hardware

*Each Kit Includes:
(2) Plow Markers
(1) Hardware Kit*

ORDERING INFORMATION

PART #	Description
EBT-PM-30-LD	30" Plow Marker Kit / Screw Base
EBT-PM-30	30" Plow Marker Kit / Municipal Base
EBT-PM-36	36" Plow Marker Kit / Municipal Base
EBT-PM-48	48" Plow Marker Kit / Municipal Base

sabre® HARDWARE



ORDERING INFORMATION

PART # / Description

- EBT-HWK-SAB-36** / 36" Sabre / 5 Bolt Kit
- EBT-WK-SAB-48** / 48" Sabre / 6 Bolt Kit
- EBT-WK-SAB-WP** / Sabre Wear Plate / 4 Bolt Kit

- EBT-WK-CG-HD** / Heavy-Duty Curb Guard / 3 Bolt Kit
- EBT-WK-CG-LD** / Light/Medium-Duty Curb Guard / 2 Bolt Kit
- EBT-WK-VB** / Sabre_V Blade / 14 Bolt Kit

REPLACEMENT SPREADER CHAINS



SPREADER CHAINS

- All Replacement Chains Manufactured In-House
- Substantial Savings Over Other Manufactured Replacement Chains
- Special Double Welded Process With a Quality Guarantee
- Overnight Shipping Available

MEASUREMENTS

(Use Illustration on the right)

- A** Center to Center _____
- B** Bar Type _____
- C** Bar Spacing _____
- D** Chain Link Style _____
- E** Pitch Size _____
- F** Hopper Length _____
- G** Weld Type (Circle One) Single / Double



CUSTOM CAPABILITIES

Please contact us today to discuss how our value added product can meet your needs.

Direct Phone: 800.733.5508

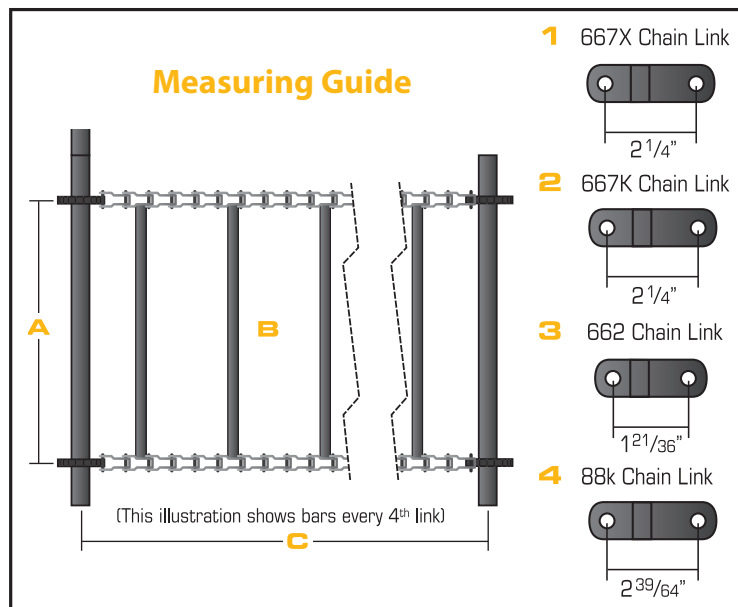

SPREADER CHAINS

		DOUBLE WELD		SINGLE WELD	
		Every Other Link	Every Link	Every Other Link	Every Link
PINTLE TYPE	Center to Center	1/4X1.0		1/4X1.0	
662	10				
	12				
	14				
	16				
	18				
	20				
	22				

		DOUBLE WELD		SINGLE WELD	
		Every Other Link	Every Link	Every Other Link	Every Link
PINTLE TYPE	Center to Center	3/8X1.5		3.8X1.5	
667X	16				
	18				
	20				
	22				
	24				
	26				
	28				
	30				

		DOUBLE WELD		SINGLE WELD	
		Every Other Link	Every Link	Every Other Link	Every Link
PINTLE TYPE	Center to Center	3/8X1.5		3/8X1.5	
667K	16				
	18				
	20				
	22				
	24				
	26				
	28				
	30				

		DOUBLE WELD		SINGLE WELD	
		Every Other Link	Every Link	Every Other Link	Every Link
PINTLE TYPE	Center to Center	3/8X1.5		3/8X1.5	
88K	16				
	18				
	20				
	22				
	24				
	26				
	28				
	30				

PRODUCT SPECIFICATIONS



WEBSITE / www.EvolutionEdges.com

PHONE / 800-733-5508

FAX / 607-732-5379

ADDRESS / 2420 Corning Road

Elmira, NY 14903

PRODUCT SPECIFICATIONS

TUNGSTEN CARBIDE TIPPED SNOW PLOW BLADES

The following specifications are being used by Evolution Edges in our manufacturing process to assure the carbide tipped snowplow blades we produced are of a superior quality.

1. **Blade**
 - a. The blade shall be hot-rolled finished steel to meet or exceed the grade requirements of A36 or 1026 type steel.
 - b. Holes shall be 11/16" square holes with countersink to receive 5/8" diameter plow bolts. Hole locations will be determined by the end user.
 - c. Center of the holes shall be within 1/32" of the established horizontal centerline and 1/16" of established vertical centerline.
2. **Tungsten Carbide Inserts**
 - a. The insert shall be a high shock WC grade of tungsten carbide with 11% to 12.5% cobalt content.
 - b. Our tungsten carbides are made of 100% virgin carbide material. No recycled materials are used.
 - c. The density of the carbide shall be 14.3 minimum to 14.6 maximum.
 - d. The hardness of the carbide shall be 88.0 minimum to 89.0 maximum
 - e. The transverse rupture strength shall be 350,000 psi minimum.
 - f. Porosity shall conform to A06, B00, C00
 - g. The shape and size of the insert shall be determined by the individual product. The tolerance on each dimension shall be as follows:
 1. 0.635 Height +/- .005"
 2. 0.365 Width +/- .005"
 3. Length 1" nominal
 4. Bottom Angle = 25 degrees(+/- 1 degree), with a nose radius of 1/16 inch (.0625) minimum
3. **Brazing**
 - a. Brazing material shall be a high strength high temp alloy type, with minimum shear strength of 30,000 psi
 - b. Inserts will be placed next to each other in the milled slot along the entire length of the cutting edge.
 - c. Inserts shall be braised on all sides consistent with sound brazing practice with no evidence of voids or use of shims.
 - d. Each blade shall contain one insert, one inch nominal length for each inch of the blade sections overall length. Several inserts in each blade may be slightly longer or shorter to ensure there will be no inserts extending from the ends of the steel portion of the blade.
4. **Milled Slot**
 - a. Slot Width .375" +/- .005
 - b. Slot Depth .635" +/- .005
5. **Additional Specifications**
 - a. The difference between the highest and lowest tip point on any two adjacent inserts is not to exceed 1/32" on any given blade assembly.
 - b. Longitudinal deviation will not exceed 1/8" in a 4' blade section.



WEBSITE / www.EvolutionEdges.com

PHONE / 800-733-5508

FAX / 607-732-5379

ADDRESS / 2420 Corning Road

Elmira, NY 14903

PRODUCT SPECIFICATIONS

RUBBER SNOW PLOW BLADES

Physical Properties:

ASTM D 412 —

TENSILE – 2400 psi (15.9 MPa) minimum

Modulus @ 100% – 500 psi (typical)

Modulus @ 200% – 900 psi (typical)

Modulus @ 300% – 1200 psi (typical)

Elongation @ Break – 450 % minimum

ASTM D2240: Hardness – 60 ± 5 Durometer (Shore A)

ASTM D 624: Tear Resistance (Die C) – 229 ppi (lbs per inch)

minimum ASTM D 297: Density / Specific Gravity – 1.135 typical

ASTM D 395: Compression Set:

22 hrs. @ 158° F – 15% typical (25% max)

22 hrs. @ 212° F – 25% typical (50% max.)

ASTM D 573: Deterioration of Properties (% Difference from Originals) (Heat Aging – Air Oven)

70 hrs. 158° F T ensile – – -20% max.

Elongation – -35% max.

Durometer – ± 6 pts. max

ASTM D 2137: Low Temperature Brittleness (- 40° F) — Pass

ASTM D 2137: Ozone Resistance (3 days @ 25 pphm) — Pass



WEBSITE / www.EvolutionEdges.com

PHONE / 800-733-5508

FAX / 607-732-5379

ADDRESS / 2420 Corning Road

Elmira, NY 14903

PRODUCT SPECIFICATIONS AND TOLERANCES

EVOLUTION EDGES STEEL BLADES

1. Blade Material:

1084 flat hot rolled steel. Brinell hardness range is 277-331.

2. Material Composition:

Carbon -	.80 - .86
Manganese -	.60 - .80
Phosphorous -	.03 maximum
Sulfur -	.04 maximum
Silicon -	.25 maximum

3. General Blade Tolerances:

Width:

Width tolerance for 6" width or less: $+1/16"$ (.125")/ $-3/32$ (-.094") from defined blade width.

Width tolerance for 8" width or more: $+1/16"$ (.125")/ $-3/16"$ (.188") Thickness:

Blade Thickness tolerances are +/- .020.

Overall Blade Length:

Blade length will be held to + 0.00 and - 1/8" (-.125") from defined blade length.

Straightness:

1/4" (.250") over a 5' length.

Flatness:

1/4" (.250") over a 5' length.

Cutoff:

Cutoff to be square, measured over the width of the blade, to:

For 6" width or less: 1/16" (.0625"). For
greater than 8" widths: 1/8" (.125").

Square Holes:

11/16" (.688") or 9/16" (.563") square holes

Punched holes to be placed in the blade at locations defined by the punch pattern.



WEBSITE / www.EvolutionEdges.com
 PHONE / 800-733-5508
 FAX / 607-732-5379
 ADDRESS / 2420 Corning Road
 Elmira, NY 14903

PRODUCT SPECIFICATIONS AND TOLERANCES

EVOLUTION EDGES STEEL BLADES

Camber Tolerances:

Maximum Camber shall not exceed the below tolerances.

CUT LENGTH, FEET (M)	CAMBER TOLERANCES, INCH (MM)
To 4 (1.2) incl.	1/16 (1.6)
Over 4 (1.2) to 6 (2.4) incl.	1/8 (3.2)
Over 6 (2.4) to 10 (3.7) incl.	3/16 (4.8)
Over 10 (3.7) to 14 (4.3) incl.	1/4 (6.4)
Over 14 (4.3) to 16 (4.9) incl.	5/16 (8.0)
Over 16 (4.9) to 18 (5.5) incl.	3/8 (9.5)
Over 18 (5.5) to 20 (6.1) incl.	7/16 (11.0)
Over 20 (6.1) to 30 (9.1) incl.	5/8 (16.0)
Over 30 (9.1) to 40 (12.2) incl.	3/4 (19.0)

Position of Holes:

From top of blade:

Print dimension +/- 1/16" (+/- .0625")

From left side of blade:

First punched hole: print dimension +0/-1/16" (-.0625")

First punched hole is to be measured from the left edge of the blade. Balance of punched holes: print dimension +/- 1/16" (+/- .0625")

Balance of punched holes to be measured from the actual position of the first hole. The print tolerance is not cumulative between holes.

Counter-Sink for Holes:

Depth of the counter-sink hole shall be adequate so the top of the bolt is flush or slightly under the surface of the blade. Countersunk square holes shall meet the requirements of SAE standard J740.

Paint:

Each blade will receive one coat of rust resistant paint.



WEBSITE / www.EvolutionEdges.com

PHONE / 800-733-5508

FAX / 607-732-5379

ADDRESS / 2420 Corning Road

Elmira, NY 14903

PRODUCT SPECIFICATIONS

HIGH CARBON STEEL GRADER BLADES

- Brinell Hardness of HB 300-350
- Chemical Composition provided below

Material		C80
Chemical Composition	C (%)	0.75-0.85
	Si (%)	0.17-0.37
	Mn (%)	0.5-0.8
	P (%)	≤0.035
	S (%)	≤0.035
	Cr (%)	≤0.25
	Ni (%)	≤0.30
	Cu (%)	≤0.25
	B (%)	-
Mechanical properties	Hardness (HRC)	≥25
	Yielding point (MPa)	≥930
	Breaking point (MPa)	≥1080
	Elongation (%)	≥6
	Impact test (room temp.)	8



WEBSITE / www.EvolutionEdges.com
 PHONE / 800-733-5508
 FAX / 607-732-5379
 ADDRESS / 2420 Corning Road

PRODUCT SPECIFICATIONS

HEAT TREATED GRADER BLADES

- Heat Treated Grader Blade Brinell Hardness of HB 440-500
- Chemical Composition provided below

Material		30MnB
Chemical Composition	C (%)	0.25-0.35
	Si (%)	0.2-1.0
	Mn (%)	1.1-1.8
	P (%)	≤0.03
	S (%)	≤0.03
	Al (%)	≤0.050
	Ni (%)	≤0.025
	Cu (%)	≤0.03
	B (%)	0.001-0.005
Mechanical properties	Hardness (HRC)	≥ 45
	Yielding point (MPa)	≥1440
	Breaking point (MPa)	≥1630
	Elongation (%)	≥9
	Impact test (room temp.)	25